



# HandKey<sup>®</sup> 2

## Biometric Hand Geometry Reader

*Nothing is tougher!*

Our HandKey-2 product is ideal for applications where consistent and dependable security is of prime importance. The product is easy to maintain, and provides an ideal mix of convenience, security and peace of mind.

### *Top 10 reasons to select Hand Geometry*

#### FIELD PROVEN RELIABILITY

1. Hundreds of thousands of HandKeys are installed all over the world in diverse applications providing millions of error free transactions every day

#### CONVENIENCE AND COST SAVINGS

2. Incredibly fast installation & intuitive enrollment increases user convenience
3. Verification in less than 1 second makes it ideal for high throughput applications
4. High product quality + low maintenance costs = Low total cost of ownership
5. Eliminate the worry of lost, stolen or unauthorized transfer of ID cards plus the cost of purchasing and maintaining these cards

#### ELIMINATE PRIVACY CONCERNS

6. Hand Geometry technology is well accepted by end users as there are NO fingerprints or palm prints taken and the user does not leave behind any trace of their biometric data

#### AMAZING VERSATILITY

7. HandKeys can be used as standalone systems to protect critical access points that can be easily integrated into virtually every new or existing access control system in the market today
8. Ability to customize user specific security levels, time zones, holidays and languages based on your needs
9. Optional access control template management software allows the HandKeys to form a system that communicates alarms and transactions in real time, provides activity reports, allows supervised on-site or remote user enrollment and expiring privileges for temporary access
10. Environmental enclosures and integrated heater units make the HandKey an ideal solution for outdoor usage



### *Features and benefits*

- Convenience of multiple credential options such as proximity, magnetic stripe, barcode, iClass and MIFARE
- Field installable Ethernet module
- Outdoor enclosure options that make the HandKey-2 an ideal solution for outdoor usage
- Field upgradable and expandable memory options from 512 to 240,000 users for scalable security that grows with your needs
- Three user-definable outputs to connect to auxiliary devices such as audible or silent alarms, door locks or lighting systems
- Ability to write the industry's most compact biometric template on a card instead of in a database results in higher security & unlimited user capacity
- Specially formulated antimicrobial coating with silver ions on the platen to inhibit the growth of bacteria, mold and mildew to mitigate hygiene concerns. The coating is safe and lasts for the life of the product
- Blue hand outline on the platen facilitates easy enrollment and reduces error rates during verification

## Door control and monitoring

Each HandKey-2 is a complete, integrated door controller providing lock operation, request-for-exit and alarm monitoring. Biometric templates and decision-making capability reside locally, ensuring your doors are always secure and will continue to operate properly even if all communication to the main access control system is lost.

## Stand-alone or fully integrated

HandKey readers can be used as a stand-alone unit or as part of an integrated access control system. The units easily integrate into existing systems using the card reader emulation mode. Or, by using the HandNet software for template management, thousands of units can

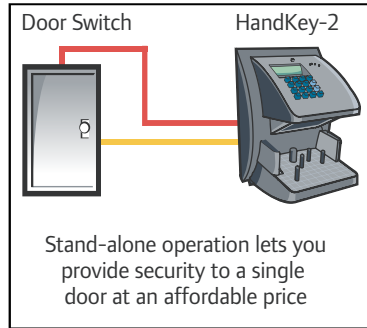

be linked together to form a system that communicates alarms and transactions in real time, provides activity, user and systems reports, and allows supervised user enrollment and deletions at any reader.

A variety of communications options, including dial-up modems and Ethernet, allow you to design a system that's right for your facilities.

## In a network

Schlage's HandNet software links a virtually unlimited number of HandKey units into an integrated door access control system. All alarms and transactions report back in real time to the central computer, making door and alarm monitoring easy and efficient. Activity, user and system reports can be easily generated. The central computer handles all hand template management allowing supervised enrollment at any reader and system wide deletions. An optional internal modem lets you include remote site operations. Ethernet communication is also available.

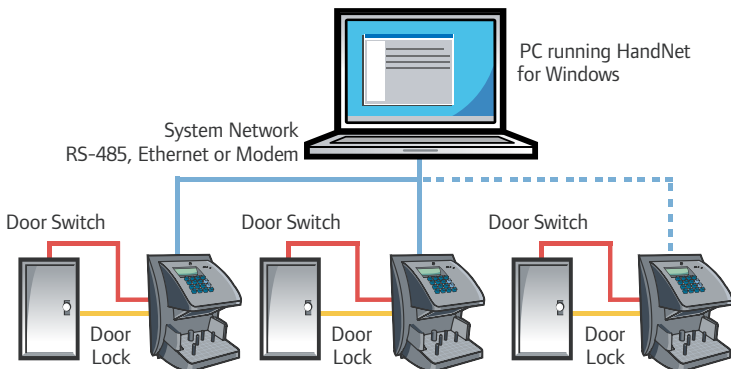

HandKey® is a registered trademark of Schlage. Specifications subject to change. Please check with your system vendor for details.

## Base Model

## HandKey-2

<b>Description</b>	HandKey with base memory for 512 users
<b>Verification Time</b>	≤ 1 second for comparison to reference template
<b>ID Number Length</b>	1 – 10 digits
<b>Duress Code</b>	1 leading digit, user definable
<b>Communication</b>	RS-232: Baud rate 300 bps to 28,800 bps RS-422: Baud rate 300 bps to 28,800 bps RS-485: Baud rate 300 bps to 28,800 bps Optional Modem: Baud rate 300 bps to 14,400 bps Optional Ethernet: 10 Base T
<b>Template Size</b>	9 bytes
<b>User Memory</b>	512 users expandable to 240,000 users
<b>Inputs</b>	Standard: 26 bit, 9 bit ID Wiegand Optional: Mag stripe, bar code, smart card HandKey input: Request to Exit, Door switch input, 2 auxiliary inputs
<b>Outputs</b>	Door control: Lock output Card reader emulation mode: Wiegand, mag stripe, bar code 1 programmable auxiliary Outputs to peripheral devices: Audible or silent alarms, door locks, lighting systems
<b>Event Monitoring</b>	Tamper: HandKey opened or removed ID refused: User not verified after user definable number of tries exceeded Duress: User entered duress code digit Power failure: HandKey switched to optional battery power
<b>Programmable HandKey Commands</b>	<ul style="list-style-type: none"> <li>• Add / remove users</li> <li>• Set global operating thresholds</li> <li>• Set individual user data (authority or threshold levels, time zones)</li> <li>• Transmit data from Master to Remote</li> <li>• Data received by Master from Remote</li> <li>• Transmit / receive data from optional software</li> <li>• Check status of door (Tamper, Door monitor switch)</li> <li>• Time zones – 62 total (2 fixed, 60 programmable)</li> <li>• Set language</li> <li>• Set date format, date and time</li> <li>• Edit holidays</li> </ul>
<b>Antimicrobial</b>	Available on Platen
<b>Blue Hand Outline</b>	Available on Platen
<b>Dimensions HxWxD</b>	11.65 in. x 8.85 in. x 8.55 in. 29.6 cm x 22.5 cm x 21.7 cm
<b>Power Requirements</b>	12 to 24 VDC or 12 to 24 VAC 50-60 Hz 7 Watts (without options)
<b>Weight</b>	5.3 lbs. (2.4 kgs.) (Without battery back-up or wall plate)
<b>Temperature</b>	Operating: 0 deg C to +45 deg C / 32 deg F to 113 deg F Non-Operating (Storage): -10 deg C to +60 deg C / 14 deg F to 140 deg F
<b>Relative Humidity</b>	Operating: 20% to 80% RH Non-condensing Non-operating (Storage): 5% to 85% RH Non-condensing